

Amass Product Specifications

1. Product Overview Description

XT60 series products with fixing screw holes can be installed on the device housing and are compatible with other XT60 series products

2. Application Module

☑Lithium battery ☑Motor ☑Controller ☑Charger ☑Other

3. Product Diagram

model	Product images	Appearance drawing
XT60E1-M.G.*		

4. Specifications

Material	Specification	plating	Coating thickness
Metal	H59-1	G: Thick gold plating (Au)	0.03 μ m
material	Specification	color	Flame retardant grade
Plastic shell	PA66	*:Y=yellow	UL94-V0

5. Characteristics table

Electrical performance	Test Method	characteristic
Withstand voltage	UL1977	DC 500V
Rated current Contact	UL1977	20A 16#
resistance Insulation	GB/T5095.2	0.60m Ω
resistance	GB/T5095.2	2000M Ω
Instantaneous current	&A 1min γ 80 γ	40A 16#
Temperature rise	UL1977	20A 4h γ 60 γ 16#
Creepage distance	GB/T2900.18	2.90mm
Creepage distance	standard	characteristic
Mechanical properties Insertion force	GB/T5095.8	1.8kg-4.5kg
Pull-out	GB/T5095.8	1.8kg-4.5kg
force plug-in life	GB/T5095.1	100 times
Protection level	GB/T4208	IP40
Environmental	standard	characteristic
performance Operating	GB/T 2423.3	-20 γ to 120 γ
temperature Salt spray	GB/T 2423.17	48h

6. Wiring Recommendations

AWG	Temperature rise 60 γ	Temperature rise 85 γ
12#	40A	45A
14#	30A	35A
16#	25A	30A

7. Optional Instructions

• With back cover • With buckle • Waterproof • Anti-fire

8. Certification of qualifications

• UL • CE • RoHS 2.0 • Reach

IX. Installation Recommendations

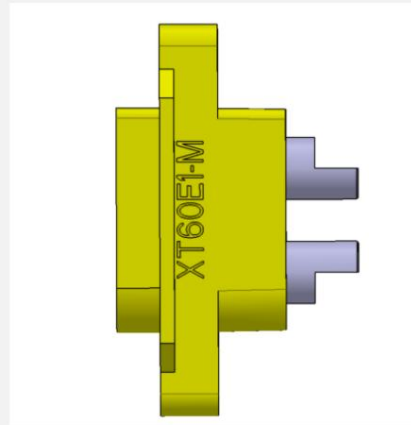
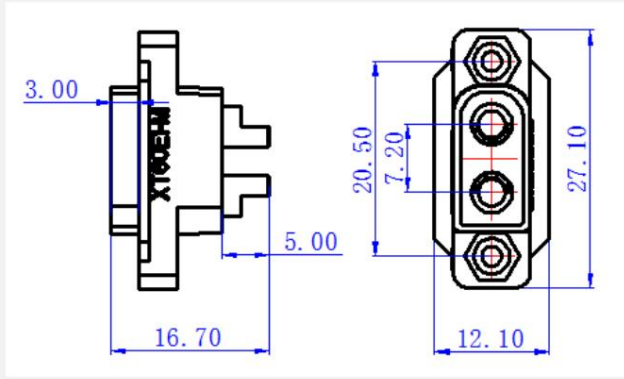

Note: When

using, do not exceed the rated current and voltage.



- Current and voltage overloads can cause malfunctions and accidents.
 - If you plug or unplug the connector while it is powered on, it may cause malfunctions and accidents.
- You plug or unplug the connector when the power is off.

Do not use the connector while applying external force.



- Do not power on the connectors and wires when they are under stress. If they are subjected to excessive external force, they may break and Malfunctions and accidents may occur, so please do not use it in this situation.
 - The connector is designed as a connecting part of the circuit, so do not use the connector as a component of the housing.
- Used as part of a structure.

Please confirm the usage environment



- Do not use in places with high temperature or high humidity.
 - If the environment is not specified in the specification, it may cause malfunction.
- Use in case of

Please use with caution



- The connector is a precision component, please be careful when using it.
 - Please be careful when opening the package, even if it is packed with carrier tape and packaging tube.
- The product will still cause the terminals to deform, bend, or fall out after being hit hard.

prepared by:

Audit:

approve: